

110kV STÍŽAR - N

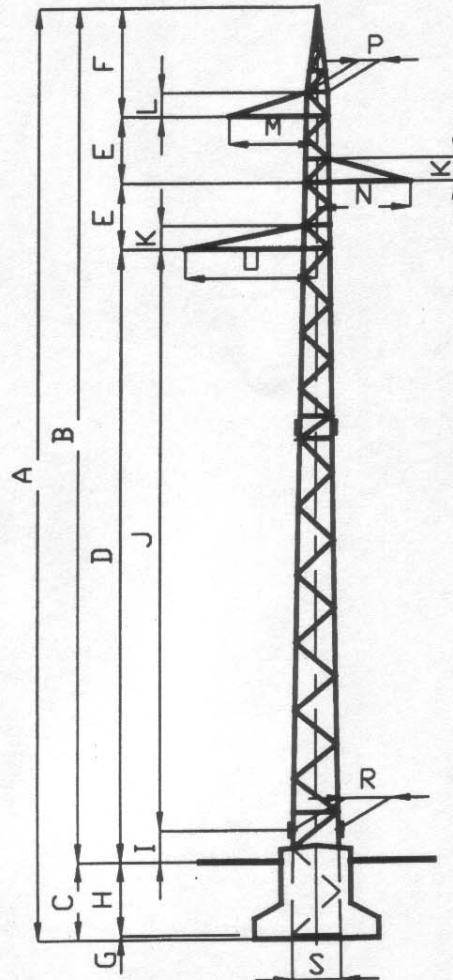

ROZM.	TYP STÍŽARU						
	N	N+4	N+8	N+12			
A	24000	28000	32000	36000			
B	21900	25900	29900	33900			
C	2100	2100	2100	2100			
D	15700	19700	23700	27700			
E	1700	1700	1700	1700			
F	2800	2800	2800	2800			
G	100	100	100	100			
H	2000	2000	2000	2000			
I	800	800	800	800			
J	14900	18900	22900	26900			
K	680	680	680	680			
L	600	600	600	600			
M	2300	2300	2300	2300			
N	2400	2400	2400	2400			
O	3400	3400	3400	3400			
P	550	550	550	550			
Q	1246	1390	1534	1678			
R	1344	1488	1632	1776			

# 1x220kV PORTÁL – N (Ns)

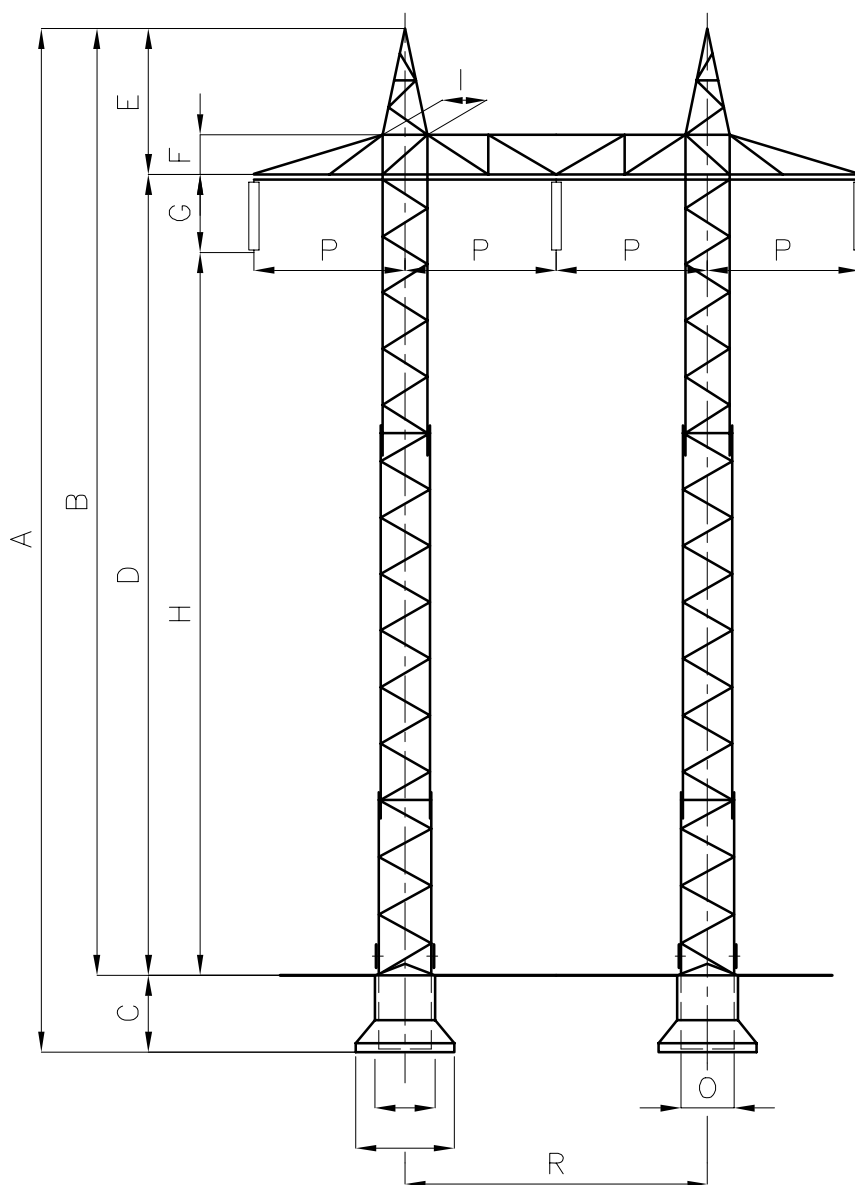

TYP STOŽÁRU

ROZM.	N	N+4	N+8	N+12	Ns	Ns+4	
A	27000	31000	35000	39000	27000	31000	
B	25000	29000	33000	37000	25000	29000	
C	2000	2000	2000	2000	2000	2000	
D	21000	25000	29000	33000	21000	25000	
E	4000	4000	4000	4000	4000	4000	
F	1200	1200	1200	1200	1200	1200	
G	3000	3000	3000	3000	3230	3230	
H	18000	22000	26000	30000	17770	21770	
I	1000	1000	1000	1000	1000	1000	
J							
K							
L							
M							
N							
O	1036	1036	1060	1040	1044	1044	
P	4000	4000	4000	4000	4500	4500	
R	8000	8000	8000	8000	9000	9000	